

Where learning comes to life!

Where are we?



Situated on the beautiful Hampshire coast, Stubbington Study Centre is a Children's Services facility available to schools and other pre-booked groups for residentials and more.



https://www.youtube.com/watch?v=fa4_hmKXPPU

Stubbington Study Centre - new dorm layout 2014 (Not to scale)

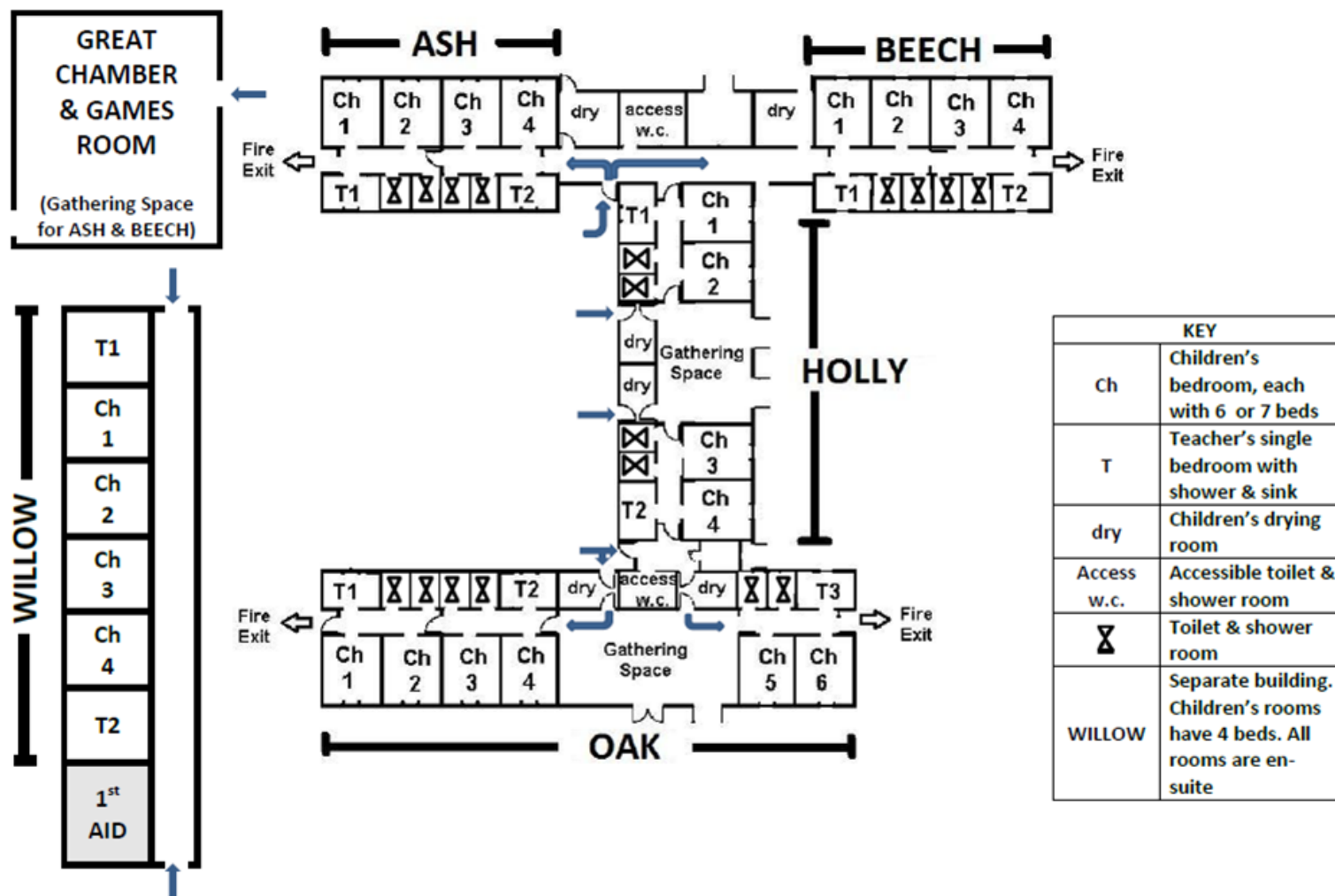



Coaches arrive around 10:15am

Children are shown to their dormitories.

They begin to think about our three key words:



Teamwork

Responsibility

Respect



Our towels will soon dry in here!

Drying Rooms



**Welcome to
Stubbington**

We all meet in
the Great
Chamber for a
welcome and
introduction.



Study Bases for indoor work

Study Bases

Ooh! Is that a stick insect?

No! It is a stick!





We can
provide
wellingtons,
waterproofs,
clipboards
etc.



Our first day!



Children ready for breakfast at 8:20am



Inside the dining room

Children
build a
healthy
appetite!





Tuck shop opens after lunch





Games Room
Pool, Table tennis,
Games machines and
more...



Our hard court areas

Our Adventure Playground



...only used under adult supervision.

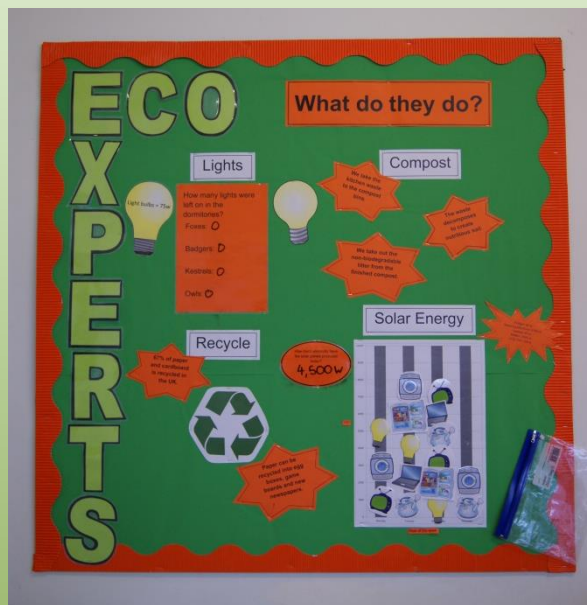

Weather, Bird and Eco-Experts

Activities!

A photograph of two children, a boy and a girl, crouching in a field of tall grass and weeds. The boy, wearing a red shirt and dark pants, is holding a metal Longworth small mammal trap. The girl, wearing a blue hoodie and dark pants, is looking down at the trap. A black plastic funnel is placed next to the trap. The background is filled with green vegetation and a fallen log.

Good Luck!

A Longworth small mammal trap



I'm a
Woodmouse



I'm a Bank
Vole



Mammal Study



Most of the time will be spent
working in our 'outdoor
classroom'!





Explore replica artefacts and historical sources.



This is our brand new Anglo
Saxon Longhouse!

Seashore Activities: all seashore activities are led by a member of Centre staff.





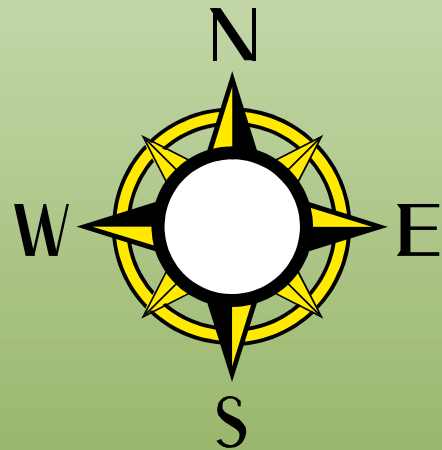

Orienteering



House Challenges



On-site first aid support



Shhh! Here
they come!



Children will
visit the hide
late one evening
to spy on the
wildlife.

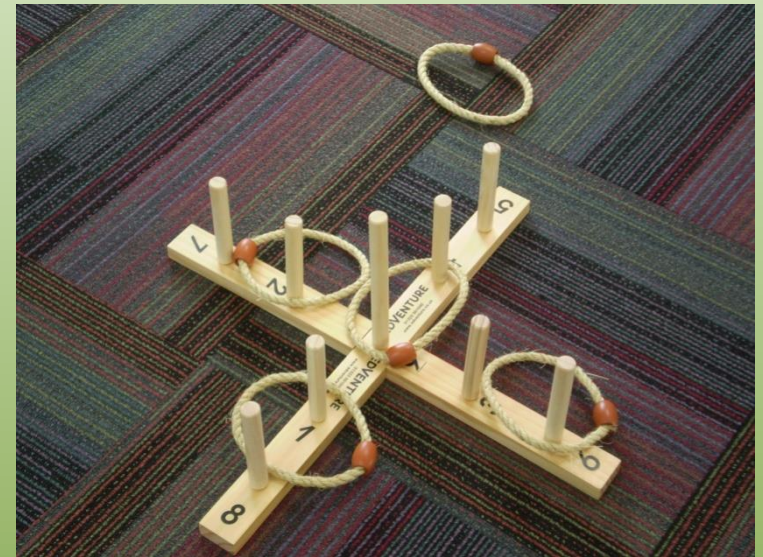

Bedtime Games

21:30

Good
night!

z

z

z

Lights out. Night night!

Friday 1:15pm the centre staff
wave the children off

The wheels on
the bus go
round and
round....



Our trip

- The dates of the trip TBC. They will be Feb/March 2025
- Each day will involve a wide variety of activities and teambuilding exercises, many of these will be supporting our curriculum:
 - Exploring an Anglo Saxon Longhouse
 - Beach explorations
 - Teambuilding orienteering activities to support our PE curriculum
- We will be staying at Stubbington for 2 nights.
- We strongly recommend that all children attend the trip as it is a great opportunity for their learning to come to life!

What do you need to do next?

- A letter was sent out on Thursday 16th November outlining the approximate cost of the trip (£190) which includes 3 cooked meals a day, all activities, accommodation and coach journey.
- You must let the school know by **Monday 13th December** **along with a £20 deposit** if you would like your child to attend.
- Please follow the instructions on the letter as to how to send the deposit to school.
- Payment reminders will be sent out for when other payments will be due.
- If you have any further questions, please either speak to your class teacher at the end of any day.